









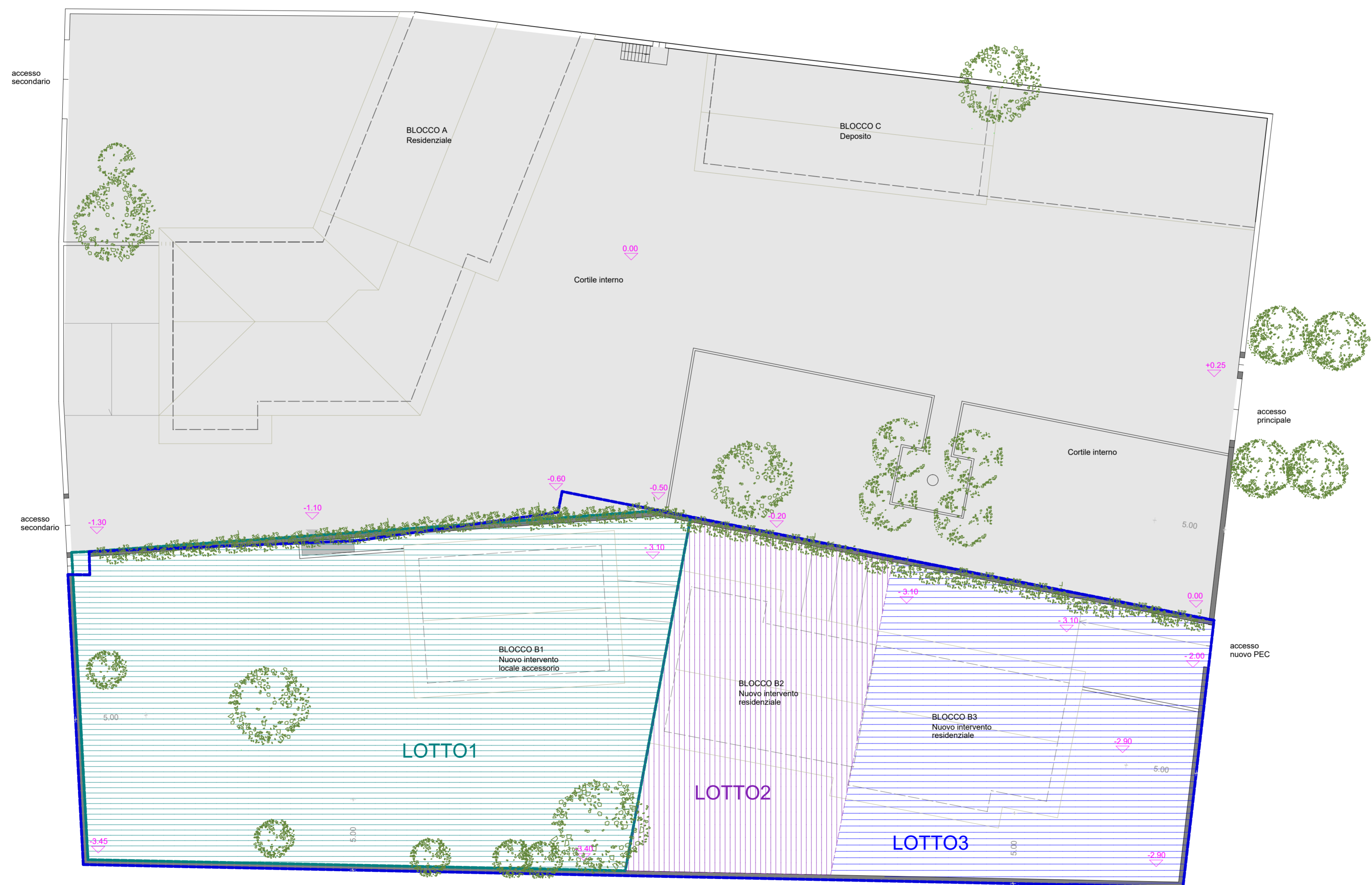

PLANIMETRIA scala 1.200
Lotti di intervento

-  lotto 1 Sf 970,0 mq Vmax 380,0 mc
-  lotto 2 Sf 350,0 mq Vmax 380,0 mc
-  lotto 3 Sf 503,0 mq Vmax 380,0 mc

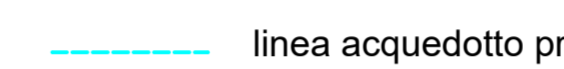

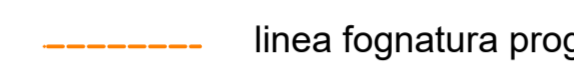
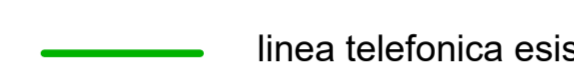
PLANIMETRIA scala 1.200
Reti servizi esistenti e progetto

-  linea ENEL esistente
-  linea ENEL progetto
-  linea acquedotto esistente
-  linea acquedotto progetto
-  linea fognatura esistente
-  linea fognatura progetto
-  linea telefonica esistente
-  linea telefonica progetto

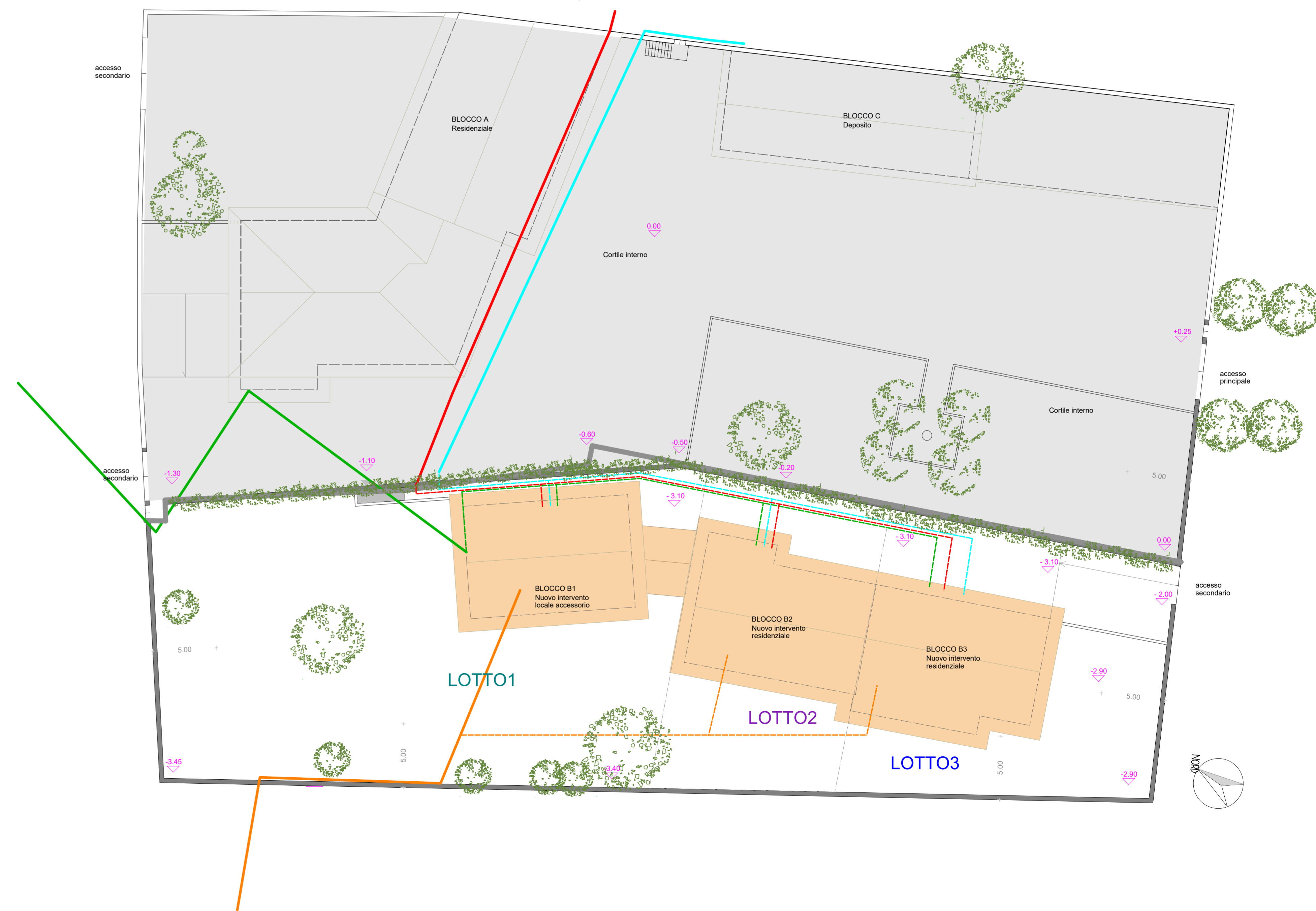

Provincia di CUNEO

Comune di VILLANOVA M.VI
Ambito P.R.G.C. zona Agricola E

PIANO ESECUTIVO CONVENZIONATO

PROGETTO MUNICIPALE

OGGETTO **STATO PROGETTO**
Planimetria suddivisione lotti
Planimetria reti urbanizzazione

SCALA: 1.200

AGGIORNAMENTO
06.06.2018

05A
TAVOLA

COMMITTENTE

BONELLI Flavio

I TECNICI INCARICATI

Boetti Gabriele Geometra Via IV Novembre,24, 12089 Villanova Mondovì - tel.333.9763306 - e-mail gabri.boetti@gmail.com
Boetti Ilaria Architetto Via IV Novembre,24, 12089 Villanova Mondovì - tel.333.5740602 - e-mail ilia.boetti@gmail.com
Comino Giorgio Geometra Via IV Novembre,24, 12089 Villanova Mondovì - tel.0174.699344 - e-mail info@studiobotticominio.it